

PD02

Pro Dome 2 Camera

Quick Start Guide



The Eagle Eye Pro Dome 2 is a high-performance 5 Megapixel dome camera with a varifocal 2.7–13.5 mm lens. This model is suitable for indoor and outdoor use for a wide range of applications. The cameras are pre-configured to securely operate with the Eagle Eye Cloud VMS. Follow the instructions in this guide to correctly install the camera and add it to the Eagle Eye Cloud VMS.



1 Check the Package Contents

Open the package and check the product for obvious damage. Confirm that all items in the packing list are included in the box.

PACKING LIST

- Pro Dome 2 Camera
- Mounting Accessories Package
- Card with QR link to this Quick Start Guide
- Installation Template Sticker

The Pro Dome 2 dimensions are below in millimeters.

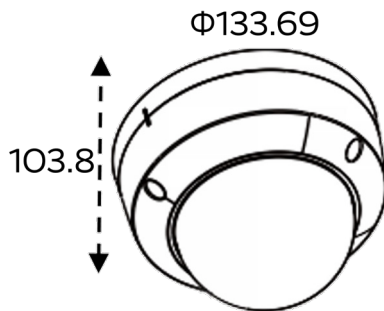

2 Remove the Dome Cover

Use the T10 screwdriver in the accessory package to remove the three screws on the dome cover.

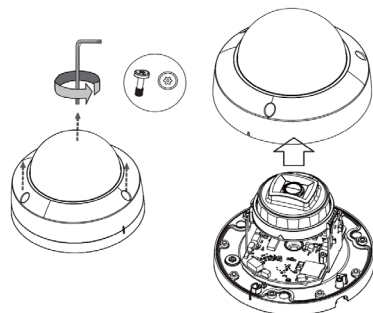

3 Prepare the Installation Site

Attach the hole-pattern template sticker to the wall or ceiling where you want to install the camera. Drill two holes in the wall or ceiling as indicated on the sticker, and then remove the template. Drive the plastic anchors into the holes.

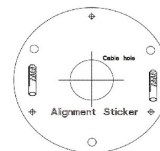

Note: If installing the camera outdoors, use weatherproof grommets (included in the accessory package).

4 Install an SD Card (Camera Direct)

If you are using Camera Direct, install an SD card in the SD slot on the camera.

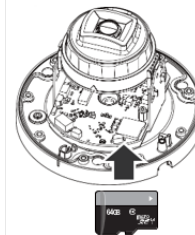

5 Connect the Camera to a Power Supply

Attach an Ethernet cable to connect the camera to a network switch.

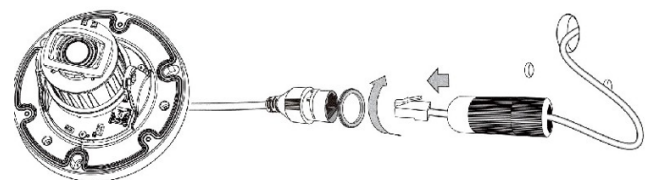

6 Attach the Camera

Align the camera with the holes in the wall or ceiling. Attach it using the included screws.

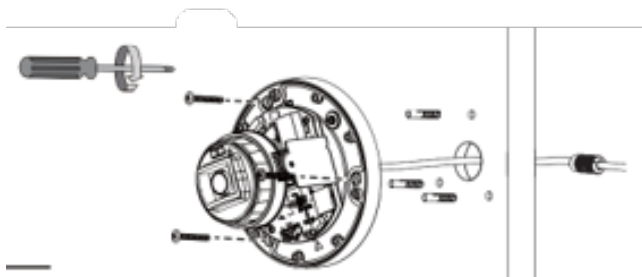

7 Add the Camera to the Cloud VMS

We recommend using the Eagle Eye Viewer mobile application to add the camera to your Cloud VMS account.

To add the camera through the Eagle Eye Viewer app:

- Navigate to the **Dashboard** and click the plus icon in the top right.
- To add the camera to a bridge or CMVR:
 - Select **Add Camera**.
 - Choose the camera you just connected from the list of **Available Cameras**. Select the bridge or CMVR where you want to add the camera.
 - Name the camera and choose **Save**.
- To add the camera directly to the cloud:
 - Select **Add Direct to Cloud**.
 - Name the camera.
 - Scan the QR code on the camera label to add the camera by its MAC address.
 - Select **Add Camera**.

Alternately, you can add the camera using the Eagle Eye Cloud VMS web interface. To add the camera through the web interface:

- Go to the **Dashboard**.
- To add the camera to a bridge or CMVR:
 - Go the list of **Available Cameras**.
 - Click the green plus icon next to the camera you just connected from the list of **Available Cameras**.

LEARN MORE

For more information about Eagle Eye Cameras, visit

www.een.com/hardware/security-cameras/

- If there are multiple bridges or CMVRs on the account, select the bridge or CMVR where you want to add the camera.
- Name the camera and choose **Save**.
- To add the camera directly to the cloud:
 - Select the ellipsis icon <...> and choose **Add Camera Direct** from the drop-down menu.
 - In the **Add Camera Direct** dialog, name the camera and enter its MAC address.

Note: The camera is initially shown as offline on the dashboard. After two minutes, it should appear online (denoted by a green check mark).

8 Adjust the Viewing Angle

- Go to **Layouts** in the Eagle Eye Viewer and locate the camera you just added.
- Use the **Preview** tile to check the camera's viewing angle as you adjust the lens manually.
- Adjust the camera's viewing angle by rotating the camera three ways: horizontally, vertically, and axially. The camera can rotate vertically 0–75°. The outer sphere can rotate 0–352°. The inner lens can rotate 0–352°.

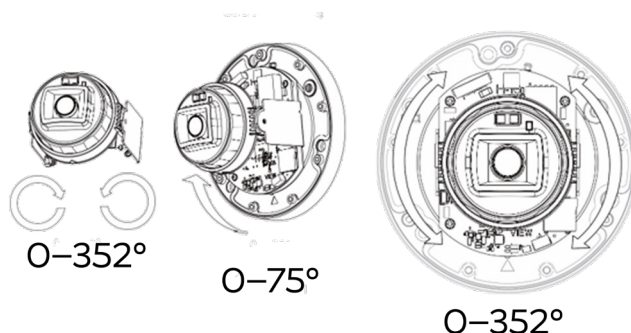

9 Replace the Dome Cover

When the desired field of view is reached, replace the dome and secure it with the T10 screwdriver.

